

The battery is designed with AGM technology, high performance plates and electrolyte to gain extra power output for common power backup system applications widely used in the field of UPS, Emergency Lighting System and other backup applications.

General Feature

- Sealed and maintenance free operation.
- Non-Spillable construction design.
- ABS containers and covers (UL94HB, UL94V-0) optional.
- Safety valve installation for explosion proof.
- High quality and high reliability.
- Exceptional deep discharge recovery performance.
- Low self-discharge characteristic.
- Flexibility design for multiple install positions.

Application

- Alarm System
- Cable Television
- Power tools
- Emergency Power System
- Security System
- Medical Equipment
- UPS
- Power tools
- Control Equipment
- Toys

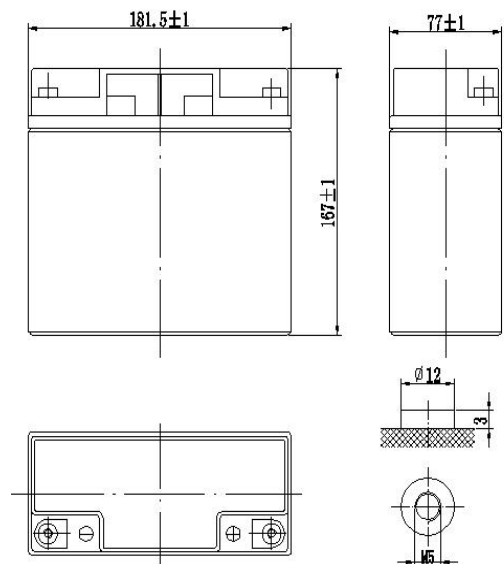

CONSTRUCTION								
Component	Positive plate	Negative plate	Container	Cover	Safety valve	Terminal	Separator	Electrolyte
Raw material	Lead dioxide	Lead	ABS	ABS	Rubber	Copper	Fiberglass	Sulfuric acid

TECHNOLOGY PARAMETER				
Battery model	MK12-18			
Designed Floating Life	5 Years			
Capacity	20hR(0.9A, 10.5V)	10hR(1.74A, 10.5V)	5hR(3.04A, 10.5V)	1hR(12.1A, 9.60V)
	18Ah	17.4Ah	15.2Ah	12.1Ah
Dimensions	Length	Width	Height	Total Height
	181.5±1mm	77±1mm	167±1mm	167±1mm
Approx. weight (±3%)	5.5Kg			
Internal resistance	Full charged at 25°C: Approx. 15mOhms			
Self-discharge	3% of capacity declined per month at 25°C (average)			
Capacity Affected	40 °C	25 °C	0 °C	-15 °C
by Temp.(20HR)	102%	100%	85%	65%
Charge Voltage (25°C)	Cycle use		Float use	
	14.5-14.9V(-30mV/°C), max. Current: 5.4A		13.6-13.8V(-20mV/°C)	

End Point	5min	10min	15min	30min	1h	3h	5h	10h	20h
Volts/Cell									
1.60V	71.00	49.70	37.80	21.30	12.10	5.08	3.32	1.830	0.950
1.65V	67.40	47.50	36.00	20.50	11.90	4.91	3.22	1.800	0.920
1.70V	63.40	44.80	34.10	19.60	11.60	4.75	3.13	1.770	0.910
1.75V	59.50	42.10	32.30	18.60	11.10	4.54	3.04	1.740	0.900
1.80V	55.50	39.90	30.40	17.70	10.60	4.34	2.95	1.710	0.880

End Point	5min	10min	15min	30min	1h	3h	5h	10h	20h
Volts/Cell									
1.60V	131.00	91.90	70.40	39.80	22.80	9.59	6.30	3.50	1.81
1.65V	124.00	87.30	66.60	38.00	22.20	9.23	6.09	3.42	1.76
1.70V	116.00	82.00	62.80	36.20	21.60	8.88	5.89	3.34	1.73
1.75V	108.00	76.70	59.10	34.20	20.50	8.45	5.68	3.28	1.70
1.80V	99.80	71.90	55.10	32.10	19.30	7.98	5.45	3.18	1.65

