

The battery is designed with AGM technology, high performance plates and electrolyte to gain extra power output for common power backup system applications widely used in the field of UPS, Emergency Lighting System and other backup applications.

General Feature

- Sealed and maintenance free operation.
- Non-Spillable construction design.
- ABS containers and covers (UL94HB, UL94V-0) optional.
- Safety valve installation for explosion proof.
- High quality and high reliability.
- Exceptional deep discharge recovery performance.
- Low self-discharge characteristic.
- Flexibility design for multiple install positions.

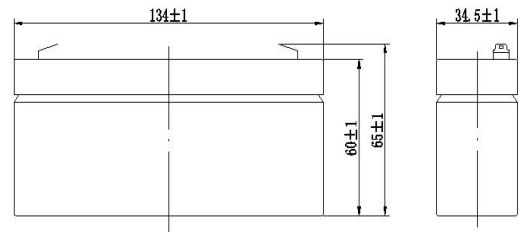

Application

- | | |
|------------------------|-------------------|
| Alarm System | Medical Equipment |
| Cable Television | UPS |
| Power tools | Power tools |
| Emergency Power System | Control Equipment |
| Security System | Toys |

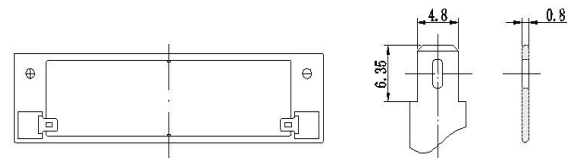

CONSTRUCTION								
Component	Positive plate	Negative plate	Container	Cover	Safety valve	Terminal	Separator	Electrolyte
Raw material	Lead dioxide	Lead	ABS	ABS	Rubber	Copper	Fiberglass	Sulfuric acid

TECHNOLOGY PARAMETER				
Battery model	MK6-3.4			
Designed Floating Life	5 Years			
Capacity	20hR(0.165A, 5.25V)	10hR(0.299A, 5.25V)	5hR(0.52A, 5.25V)	1hR(2.08A, 4.80V)
	3.4Ah	2.99Ah	2.6Ah	2.08Ah
Dimensions	Length	Width	Height	Total Height
	134±1mm	34.5±1mm	60±1mm	65±1mm
Approx. weight (±3%)	0.64Kg			
Internal resistance	Full charged at 25°C: Approx. 30mOhms			
Self-discharge	3% of capacity declined per month at 25°C (average)			
Capacity Affected	40 °C	25 °C	0 °C	-15 °C
by Temp.(20HR)	102%	100%	85%	65%
Charge Voltage (25°C)	Cycle use		Float use	
	7.25-7.45V(-15mV/°C), max. Current: 0.99A		6.8-6.9V (-10mV/°C)	

End Point	5min	10min	15min	30min	1h	3h	5h	10h	20h
Volts/Cell									
1.60V	11.20	7.86	5.98	3.37	2.08	0.87	0.57	0.314	0.173
1.65V	10.70	7.50	5.69	3.23	2.04	0.84	0.55	0.309	0.169
1.70V	10.00	7.08	5.40	3.09	1.98	0.81	0.54	0.303	0.167
1.75V	9.40	6.66	5.11	2.94	1.90	0.78	0.52	0.299	0.165
1.80V	8.77	6.31	4.81	2.79	1.81	0.74	0.50	0.293	0.162

End Point	5min	10min	15min	30min	1h	3h	5h	10h	20h
Volts/Cell									
1.60V	20.80	14.50	11.10	6.30	3.90	1.64	1.08	0.60	0.33
1.65V	19.60	13.80	10.50	6.01	3.81	1.58	1.04	0.59	0.32
1.70V	18.40	13.00	9.93	5.72	3.69	1.52	1.01	0.57	0.32
1.75V	17.10	12.10	9.34	5.41	3.52	1.45	0.97	0.56	0.31
1.80V	15.80	11.40	8.71	5.08	3.31	1.37	0.93	0.54	0.30

